

2u Vertical Wall Mount Bracket - Black

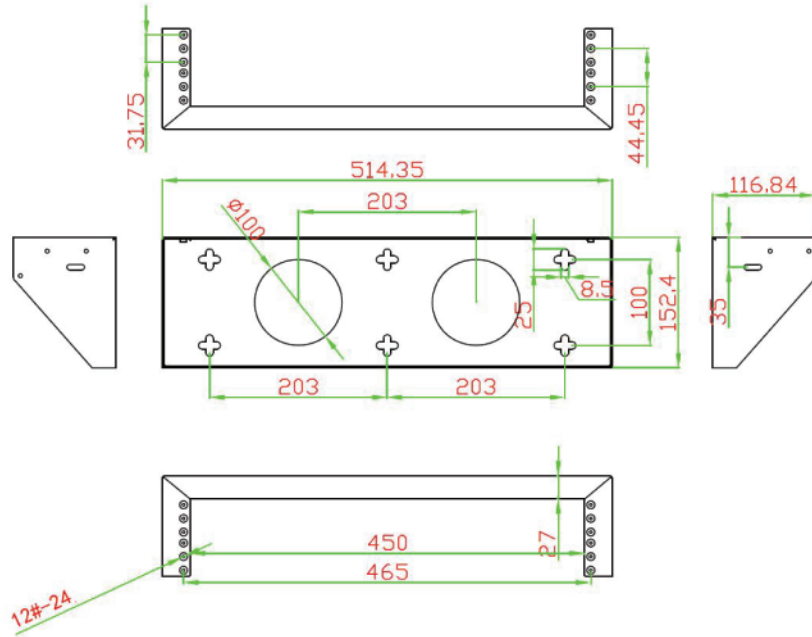

Space-Saving Design: Ideal for setups where space is at a premium, eliminating the need for bulky full-sized racks.

Standard 19 Inch Compatibility: Designed to fit all 19 inch Networkx® Patch Panels, and also compatible with non-Networkx® Patch Panels.

Universal Fit: Mounting holes align perfectly with standard wall studs, ensuring secure and straightforward installation.

Scalable for Any Project: Perfect for anything from small home installations to large enterprise projects.

Comprehensive Solution: Part of the Networkx® ecosystem, designed to meet a wide range of networking demands.

Color	Black
Depth	4.5 Inch
Height	6 Inch
Material	Cold Rolled Steel
Mount Style	Vertical Mount
RMU	2U
Warranty	Lifetime Warranty
Width	20.25 Inch